

## INSTALLATION GUIDE – DIY 6 DRAWER UNIT

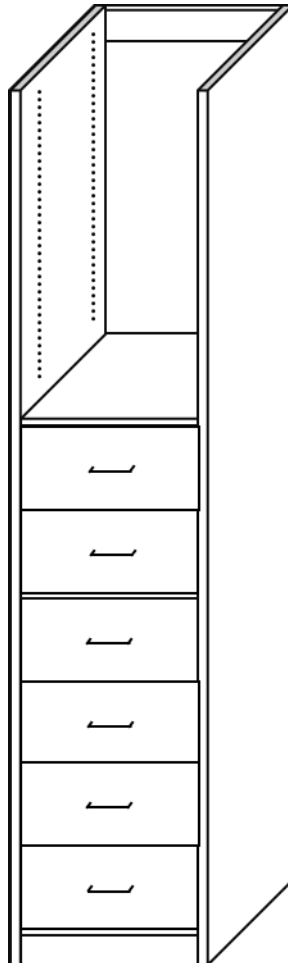

### KIT INCLUDES

- 2 Side Panels (left & right)
- 6 Drawers
- 3 Fixed Shelves (pre-drilled)
- 2 Adjustable Shelves
- 3 Support Pieces
- 1 Kicker Piece
- 12 Shelf Pins
- 28mm Chip Board Screws
- 50mm Chip Board Screws
- Screw Cap Stickers

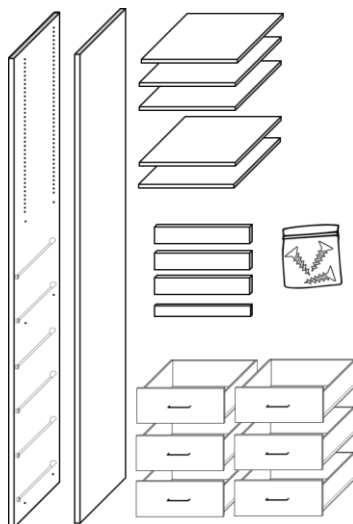

### TOOLS REQUIRED

- Tape Measure
- Drill with Phillips Head Screw Bit
- Brad Nailer Nail Gun (OPTIONAL)
- 28mm Brad Nails (OPTIONAL)
- White Gap Filler (OPTIONAL)

## INSTALLATION GUIDE – DIY 6 DRAWER UNIT

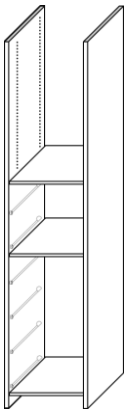

### STEP ONE

Locate all pieces, and lay flat.

Line up the left and right sides. The edged side is the front. The lowest hole at 57mm high is the bottom.

### STEP TWO

Line up a fixed shelf with the middle holes (under the 2<sup>nd</sup> runner from the top) on both side pieces. Screw together with 50mm chip board screws. Do the same for the next fixed shelf that sits under the adjustable shelf holes

### STEP THREE

Next line up the other fixed shelf with the bottom holes on both side pieces, using the kicker piece as a guide. Screw together with 50mm chip board screws.

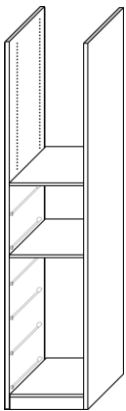

### STEP FOUR

With the bottom fixed shelf in place, line the kicker piece up under the shelf, lining up with both side of the unit.

Next depending on your tools, fix the kicker in place by following one of the below options

- Using a nail gun with 28mm Brads, fix the kicker in place through the top of the shelf into the kicker piece.
- Using a drill, fix the kicker in place with a 28mm chipboard screw in each side of the kicker.

### STEP FIVE

Now that you have the three fixed shelves and the kicker fixed in place, stand the unit upright.

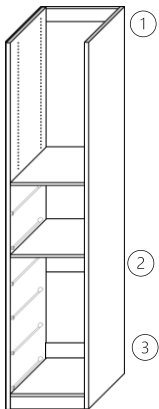

### STEP SIX

Depending on your tools, fix the 3 support pieces in place by following one of the below options

- Using a nail gun with 28mm Brads, fix the support pieces into place through both unit sides into the support piece.
- Using a drill, fix the support piece in place with a 28mm chipboard screw in each side of the support piece.

Support piece 1 – is to be placed at the top of the unit, with the edged side facing down

Support piece 2 – sits flush under the middle fixed shelf, with the edged side facing down

Support piece 3 – sits on the bottom fixed shelf with the edging facing up.

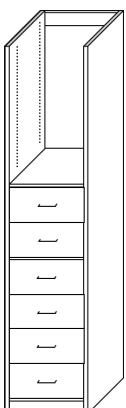

### STEP SEVEN

Move the assembled unit into place.

Attach the unit to the wall by screwing 28mm chipboard screws through the support pieces and into your wall. Multiple units can be fixed together by screwing the unit sides together.

### STEP EIGHT

Using the screw cap stickers provided, cover all screw holes.

Place shelf pins at desired heights and put adjustable shelves into place.

Insert the drawers

### STEP NINE

For a more finished look, use gap filler to caulk the gaps between the unit and your walls.

Note; if using gap filler, leave the unit empty for a minimum of 24hours to allow for the gap filler to settle and cure.